

Type V64LB12D-04Z+03ZC-...

The multi-axis controller VV 6 is a rugged switching device according IEC/EN 60947-5-1 for hoisting applications. The modular design enables the switching device to be used universally. The VV 6 is resistant to oil, maritime climate, ozone and UV radiation.

**Contact complement 2 A 250 V AC 15 or 1 A 24 V DC 13 (standard) or 4 A 250 V AC 15 (special) with positive opening operation**

Mechanical life 20 million (operating cycles)  
Permissible ambient temperature Operation -40° C to +60° C  
Storage -50° C to +80° C

Climate resistance  
Damp heat constant IEC 60068-2-78  
Damp heat cyclic IEC 60068-2-30  
Degree of protection front IP 54 IEC/EN 60529

Technical data see catalog 5/100  
Description data see catalog 5/020

Spindle block with schematic representation of the master controller installation and deflection directions.

Version shown for left-hand side installation (right-hand side installation is mirror image).

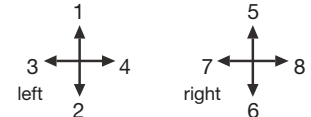

Deflection directions designated to DIN 15025

Pos.	VV 61	VV 61.1	VV 62	VV 64	VV 64.1	Type expansion		Weight gramm	Type	Price EURO
1								960	VV 61	
2								980	VV 61.1	
3								980	VV 62	
4								1010	VV 64	
5								960	VV 64.1	
7.1	Multi-axis controller left		(dir. 1-2, 3-4)						L	
7.2	Multi-axis controller right		(dir. 5-6, 7-8)						R	
10	Gate cross-shaped		(prohibits diagonal shifting)					60	P	
11	Gate special-shaped		(e.g. H-gate)					60	PX	
20	Control-handle with knob solid									
21	Control-handle with latch for mechanical zero interlock									
21.1	by lifting							50	M	
21.2	by lifting, interlocking the gate							60	MP	
21.3	by lifting, interlocking in the joint bracket							60	MP	
21.4	by pushing down							50	MN	
21.5	Mechanical zero interlock with command devices see catalog 1/274									
22	Control-handle with dead man's button 1 NO							100	T	
23	Control-handle with signal button 1 NO							100	H	
24	Control-handle with push button 1 NO							110	D	
25	Control-handle with flat push button 1 NO							110	DV	
26	Control-handle with palm grip B 1							40	B 1	
27	Control-handle with palm grip B 1 with push button top 1 NO							60	B 1T	
28	Control-handle long or short									
28.1			-40 mm						S3	
28.2			-20 mm						S5	
28.3			+20 mm						S8	
29	More knobs, grips and T-grips with and without signal devices see catalog 1/270ff									
30	Masterswitch (contact set) switching sequence 4-0-4						No. of contacts 2	290	01	
31							4	350	02	
32	Direction 1-2 and 3-4 each 1 masterswitch					A...	6	410	03	
33	Switching program according contact-arrangement MS... see catalog 5/001						8	470	04	
34	or to your contact-arrangement						10	530	05	
35							12	590	06	
36	Switching sequence 5-0-5 or 6-0-6									
38	Spring return in 0-position		(for each direction)					110	Z	
39	Friction brake adjustable		(for each direction)					30	R	
40	Potentiometer e.t.c. each direction with mounted Wire-wound potentiometer T 130, with centre tap, 1,5 Watt wiper current max. 10 mA resistance 2 x 0,5k ± P021, 2 x 1k ± P022, 2 x 2k ± P023, 2 x 5k ± P024, 2 x 10k ± P025					...P02 □		70	P	
41	Prepared for mounting potentiometer shaft 6 mm adjusting-angle 2 x 150°								(P)	
42	Prepared for mounting potentiometer e.t.c. adjusting-angle variable.					C..., P...			(P)	
43	more Potentiometer e.t.c. see catalog 1/240ff									
50	Steel sheet housing B 200 masterswitch max. size 04							1300	B	
51	Steel sheet housing B 230 x 440 masterswitch max. size 06							1600	B	
52	More housing see catalog 1/350									
60	Indicating labels not engraved with 2 or 4 arrows									
61	Engraving, each 10 characters									
70	Command and indicating devices see catalog 1/360									



T = dead man's button  
H = signal button  
M = latch for mechanical zero interlock

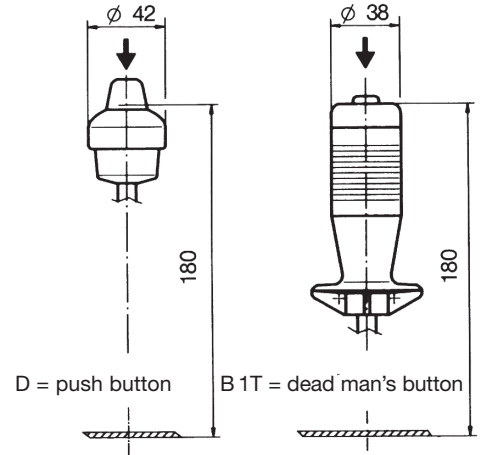
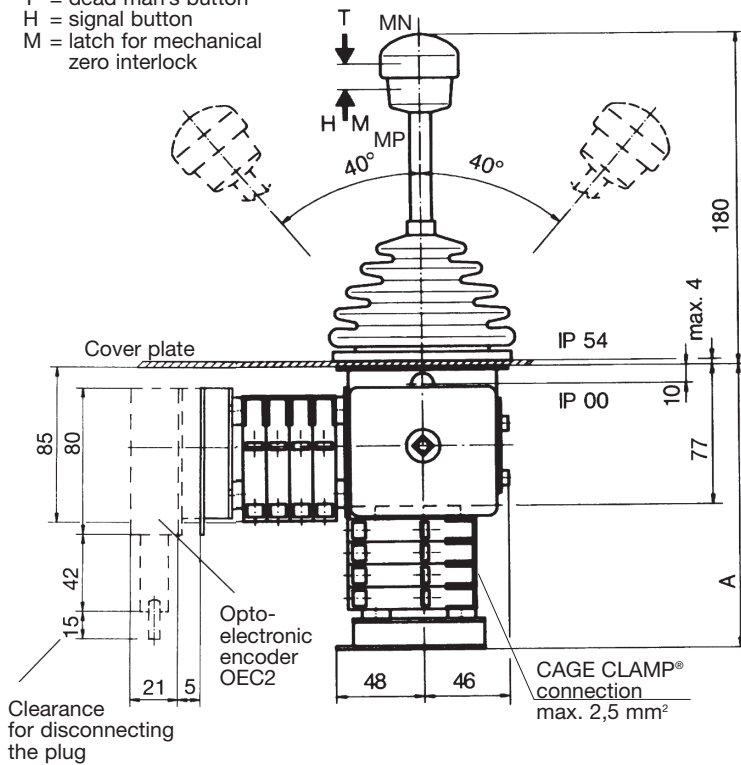

Type	No. of contacts	Dimension A	Dimension B
01	2	119	82
02	4	131	94
03	6	144	107
04	8	156	119
05	10	169	132
06	12	181	144

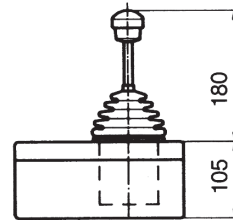
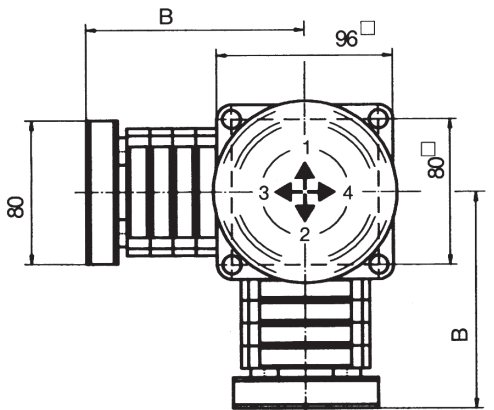

Steel sheet housing

